

**Single outputs**

**Double outputs with +/- and +/+ voltages**  
**Input to output isolated**

- Four wide 1:2 input voltage ranges
- Very high efficiency up to 85%
- Very low output voltage noise
- High reliability
- Continuous no-load and short-circuit proof
- DIL 24 case with industrial standard pinning
- No derating
- Made in Switzerland, accordingly ISO 9001:2000
- 2 years warranty

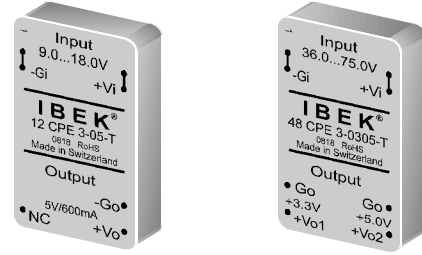

**Electromagnetic emission EN 55022 < B**

Conducted and radiated emissions

5 CPE3-types: EN 55022 < A

	5 CPE	12 CPE	24 CPE	48 CPE	
No load input current	40	20	10	5	mA typ.
Switching frequency	150 kHz min.				
Output voltage accuracy	± 2% max.				
Static line regulation	± 10 mV max.				
Static load regulation FL to 10%	0...20 mV; +/- outputs 0...1% max.				
Output voltage noise (20 MHz BW)	20 mVpp typ.				
Output current limitation response	130% typ.				
Efficiency	76% to 85% typ.				
I/O Electric strength test voltage	1500 VDC				
Coupling capacitance	1000 pF				
Ambient temperature range	-25...+71°C				
Case temperature range	-25...+95°C				
Storage temperature range	-55...+105°C				
Case material	Non-conductive plastic, UL94 V-0 rated				
MTBF, GB @ 40°C case	> 4.300.000 hours				
(MIL-HDBK-217F, Notice 2)					

Standard Types	Input voltage VDC	Output	
		VDC	mA
Single output	4.5...9 (nominal 5)	3.3	600
5 CPE3-03-T RoHS		5	500
5 CPE3-05-T RoHS		12	250
5 CPE3-12-T RoHS		15	200
5 CPE3-15-T RoHS			
Double output +/-	9...18 (nominal 12)	± 3.3	± 300
5 CPE3-0303-T RoHS <sup>1</sup>		± 5	± 250
5 CPE3-0505-T RoHS <sup>1</sup>		± 12	± 125
5 CPE3-1212-T RoHS <sup>1</sup>		± 15	± 100
5 CPE3-1515-T RoHS <sup>1</sup>			
Single output	18...36 (nominal 24)	3.3	700
xx CPE3-03-T RoHS <sup>2</sup>		5	600
xx CPE3-05-T RoHS <sup>2</sup>		12	250
xx CPE3-12-T RoHS <sup>2</sup>		15	200
xx CPE3-15-T RoHS <sup>2</sup>			
Double output +/-	36...75 (nominal 48)	± 3.3	± 350
xx CPE3-0303-T RoHS <sup>1,2</sup>		± 5	± 300
xx CPE3-0505-T RoHS <sup>1,2</sup>		± 12	± 125
xx CPE3-1212-T RoHS <sup>1,2</sup>		± 15	± 100
xx CPE3-1515-T RoHS <sup>1,2</sup>			
Double output +/+		+ 3.3 / + 5	+ 455 / + 300
xx CPE3-0305-T RoHS <sup>2</sup>		+ 2.5 / + 3.3	+ 600 / + 455
xx CPE3-2503-T RoHS <sup>2</sup>		+ 2.5 / + 5	+ 600 / + 300
xx CPE3-2505-T RoHS <sup>2</sup>			

<sup>1</sup> Double outputs should have symmetrical load conditions to comply with the specifications listed on the left side.

<sup>2</sup> To complete type number replace "xx" by the required nominal input voltage, e.g. 12 CPE3-05-T RoHS.

Modifications and customs are available upon request.

Dimensions in mm (inches)

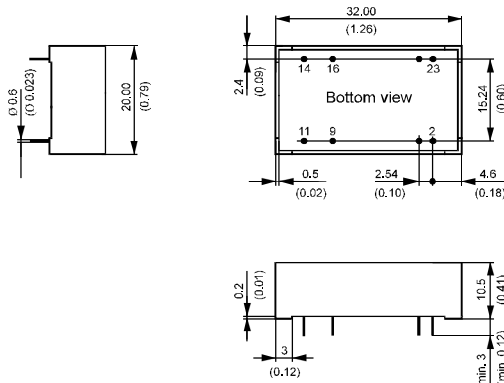

Pin Configuration			
Pin	Single output	Double output +/-	Double output +/-
2	-Gi	-Gi	-Gi
3	-Gi	-Gi	-Gi
9	No Pin	Go	Go (common)
11	NC	-Vo	+Vo1
14	+Vo	+Vo	+Vo2
16	-Go	Go	Go (common)
22	+Vi	+Vi	+Vi
23	+Vi	+Vi	+Vi

Specifications subject to change without notice